

**Before assembly study the final scene and keep in mind- It will help in Assembly**

Disclaimer: We do not claim that model is 100 % correct. This product is non-returnable and we cannot be made responsible for any loss due to printing / assembly. You may have to slightly adjust the pieces during assembly. If you wish, you may do some water color touch up here and there (after completing the model). © sanjaysrivastava  
(This work is protected under Copy Right act. You cannot reproduce it or sell it to other party in any form.)

### Assembly Instruction for both Styles

There assembly instructions for both the types of 'Maina' are common and therefore Figures are valid for both types.

- 1) Complete all internal tabs (i.e. joints within the same piece) for all the pieces. Some pieces are shown in

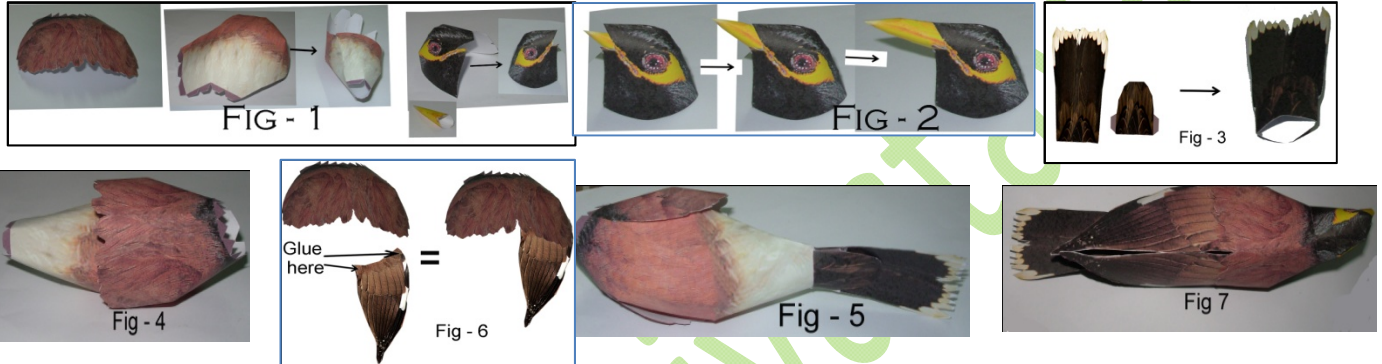
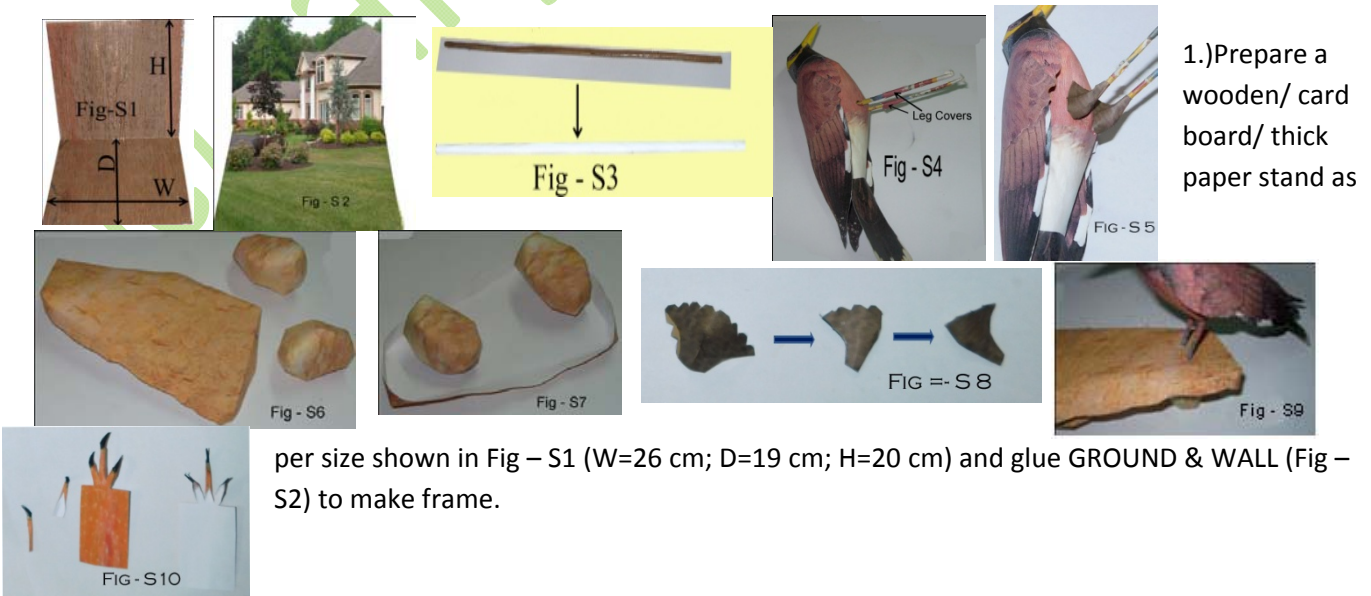

Fig - 1

- 2) Glue back to back - 'F(Right Wing)' with 'F1'; 'E(Left Wing)' with 'E1' and 'G(Tail Fin)' with 'G1'.
- 3) Fix 'Beak' to 'Head' by inserting it from inside of head (Fig - 2)
- 4) Assemble Tail fin by joining '6' with '6' and '7' with '7' (Fig - 3)
- 5) Join '1' with '1' and '2' with '2' (Fig -4) to make Body and then join 'Tail' to it (Fig - 5).
- 6) Now fix both wings to body as per Fig - 6. Finally glue the head to body (Fig-7).
- 7) Extra 'Eyes' provided may be used for more effect (if you wish).

### Assembly Instruction for complete scene



- 1.) Prepare a wooden/ card board/ thick paper stand as

per size shown in Fig - S1 (W=26 cm; D=19 cm; H=20 cm) and glue GROUND & WALL (Fig - S2) to make frame.

For more detailed and reference figures, pl visit [www.papercraftmodel.com/paper\\_craft\\_birds/maina/index.html](http://www.papercraftmodel.com/paper_craft_birds/maina/index.html) for any clarification write to [sanjaycraftmodel@gmail.com](mailto:sanjaycraftmodel@gmail.com)

***Before assembly study the final scene and keep in mind- It will help in Assembly***

2.) Take thin wooden stick (like tooth picks) 2 nos each of size 12 cm & 10 cm and wrap rough paper around it to make leg base (Fig –S3). Make small hole at appropriate place of the 'Bird-1' (Fig-5); Put some glue at the end of wooden stick of size 12 cm and insert it into bird (Fig – S4). Now prepare 'Leg Cover' ('J' & 'K' ) as per Fig-S8 and insert on these sticks and glue them on Bird body (Fig-S5).

3.) Make stones and platform by gluing their internal tabs (Fig S6). Fix 2 nos of stones on back side of platform (Fig S7). You can apply your creativity in fixing the stones on platform. Make two holes on platform and after applying some glue at the end of wooden stick, insert it into platform (Fig – S9).

4.) Now make 'Leg Pieces' ('L' & 'M') as per Fig-S10 and fix on the wooden stick as per Fig-S11 . you may have to cur few length of 'Leg Pieces' to adjust and give a fair look (as per the length of leg).

5.) Repeat these steps for 'Bird-2' with 10 cm wooden stick.



© Sanjaysrivastava